

TiX



Assistive Panel for the Use of Computers Smartphones and Tablets*

Quick Guide

This guide contains instructions for those aiming at quickly making use of the TiX Assistive Panel. In order to take advantage of all the features of the product, please, download the **full guide** from:

<http://tix.geraestec.com.br/fullguide.pdf>

Turning on TiX

To turn TiX on, you should use the USB cable that is shipped with the product. Connect the flat end of the cable to any available USB port on your desktop or laptop computer and the square end to the back input of TiX, as shown in the images below. For instructions on how to connect it to smartphones and tablets, please, see Appendix I of the guide.

After being connected, TiX lights each button's LED in sequence, until the computer recognizes it. This may take a few seconds. It will be ready for use when all LEDs lights go out.

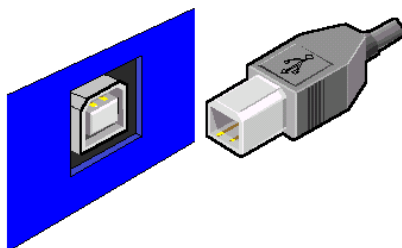
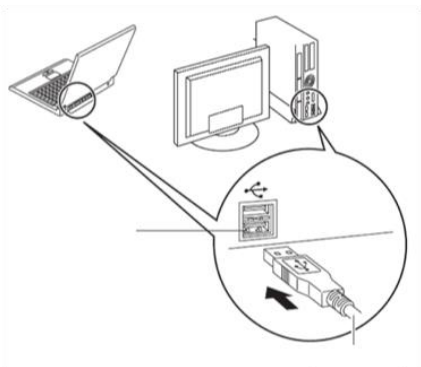

TiX in KEYBOARD mode

Once plugged into the computer, TiX starts in KEYBOARD mode. In this mode, the buttons have the function of a conventional keyboard.

How to Type?

TiX features nine combinatorial buttons for typing. Each button is touch sensitive and a different color and an icon on its top.

Around each of these buttons are shown alphanumeric characters, punctuation and commands commonly available in a conventional computer keyboard. To enter any of these characters or commands, you should activate two different combinatorial buttons on TiX in sequence.

First, touch the button where the character you want to type is located at. Note that this button will light on. Then, observe the smaller icon next to the desired character around this same button, and next touch the button that has this icon on its top. The LED lights of both buttons will turn off, and the character will be transmitted to the computer.

To type any character, such as letters or numerals, just follow the same procedure.

EXAMPLE

To enter the letter "A", first, touch the button with a "blue triangle". Then, touch the button with the "yellow moon".

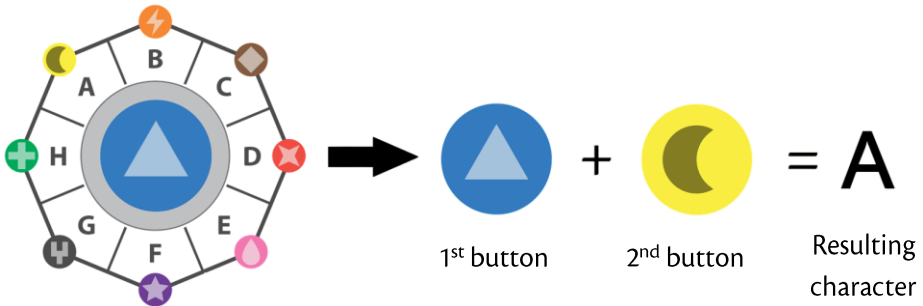

How to activate and use TiX in MOUSE mode



To activate the mouse mode on TiX, just touch the special “change mode” button three consecutive times .

MOVING THE CURSOR WITH TiX MOUSE

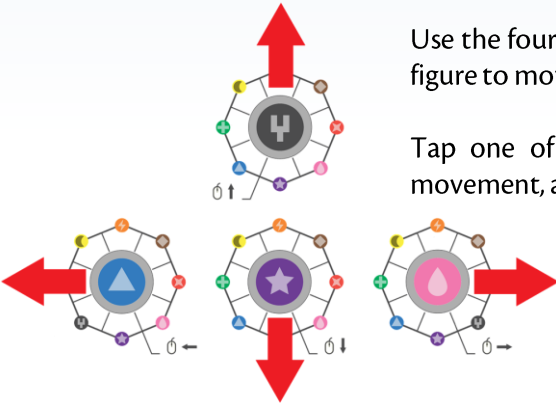

Use the four directional buttons indicated in the figure to move the pointer across the screen.

Tap one of the buttons to start the pointer movement, and tap a second time to stop it.



For the pointer to move slower, tap on the red button.



To move it faster, tap on the green button.

PRODUCING THE ACTIONS OF MOUSE BUTTONS WITH TiX MOUSE



Tap the yellow button to produce the effect of a single click on the left button of a regular mouse



Tap the orange button once to perform the effect of a double-click.

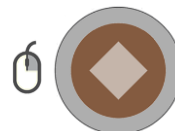

The brown button acts just like the right button of a regular mouse.

CONTROLLING THE POINTER MOVEMENT

To start the movement of the mouse's cursor just tap on the button for the desired direction. **You do not need to hold down the button.** The pointer then starts to move continuously in that direction. To stop it, simply tap on the same button again.

To select the pointer speed, use the green (increase) or red (lower) buttons. The green LEDs on top of TiX panel in MOUSE mode indicate the speed selected:

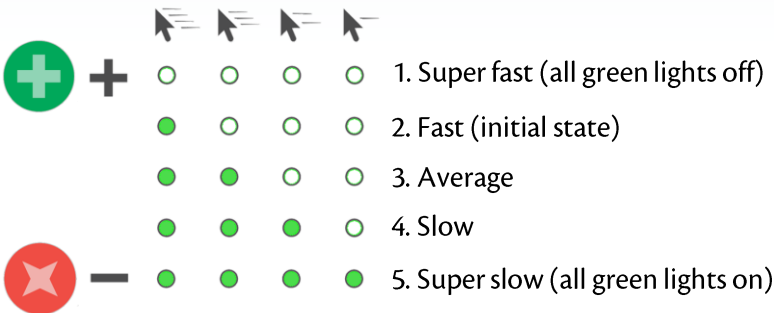

CENTRALIZING THE POINTER



In mouse mode, tap the special “change mode” button once in order to quickly place the pointer in the center of the screen*.

IMPORTANT:

When TiX is in MOUSE mode, the activation of the special “change mode” button three times in sequence causes the panel to **revert back to the KEYBOARD mode.**

* The shortcut to centralize the pointer is not available when TiX is connected to mobile devices like smartphones and tablets.